

Individual Waimea 400 Project

TEAM BA

In my design there are residential housings, public pools, baseball and football fields, a basketball and tennis courts, a park, and a large community farm.

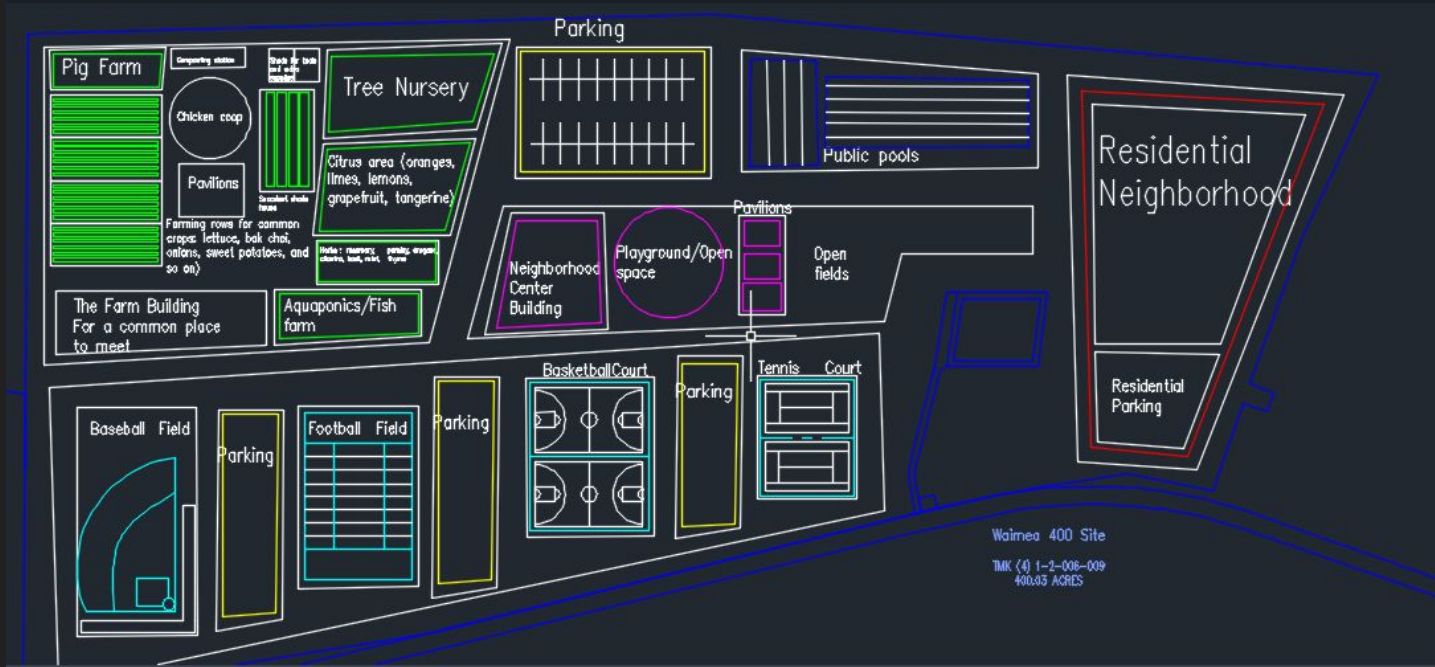

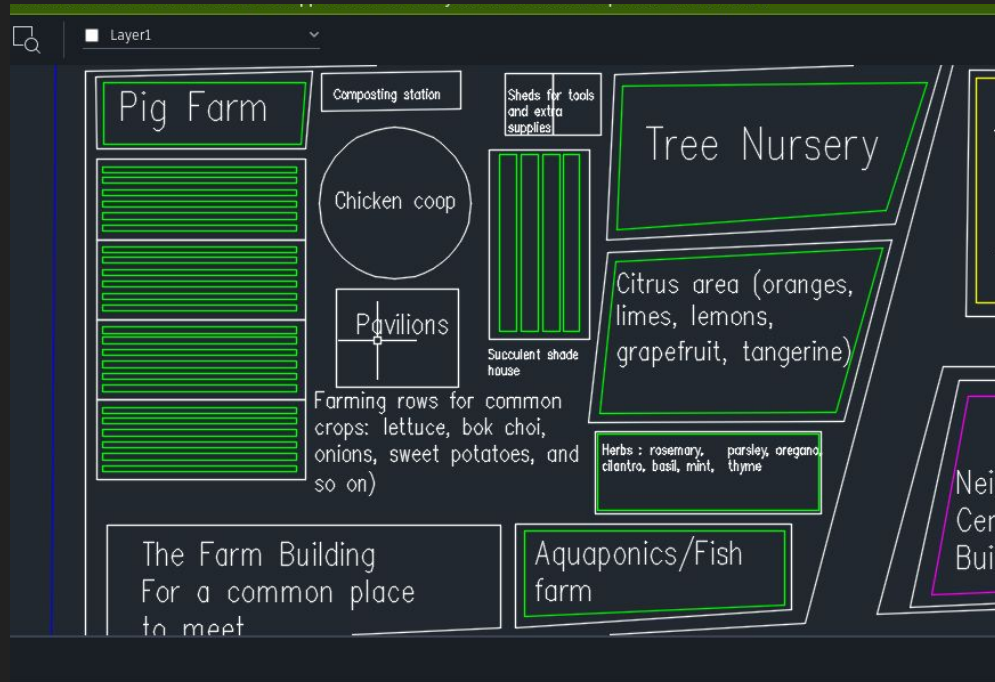

I made this community farm so resident's of the west side have more accessibility of farming crops/food, animals, tools, and space. I put the pig farm as far away from the park and sports center as possible. I also made a composting station to reduce the need for chemical fertilizer. I put the farm on the top of the site so in case of a flood the crops, animals, and the whole farm wouldn't be destroyed.

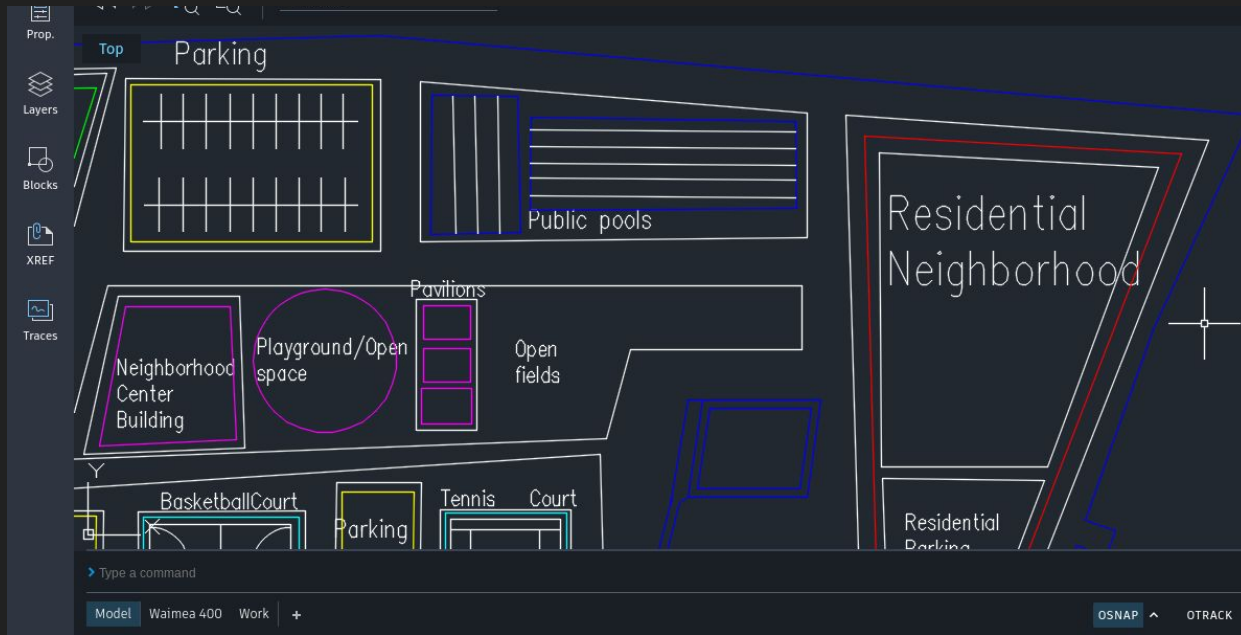

In the park there is a neighborhood center, pavilions, and playgrounds. I wanted to put the park and pool in the middle so it's close to the residential neighborhood. And I tried to put the homes away from the flood zone.

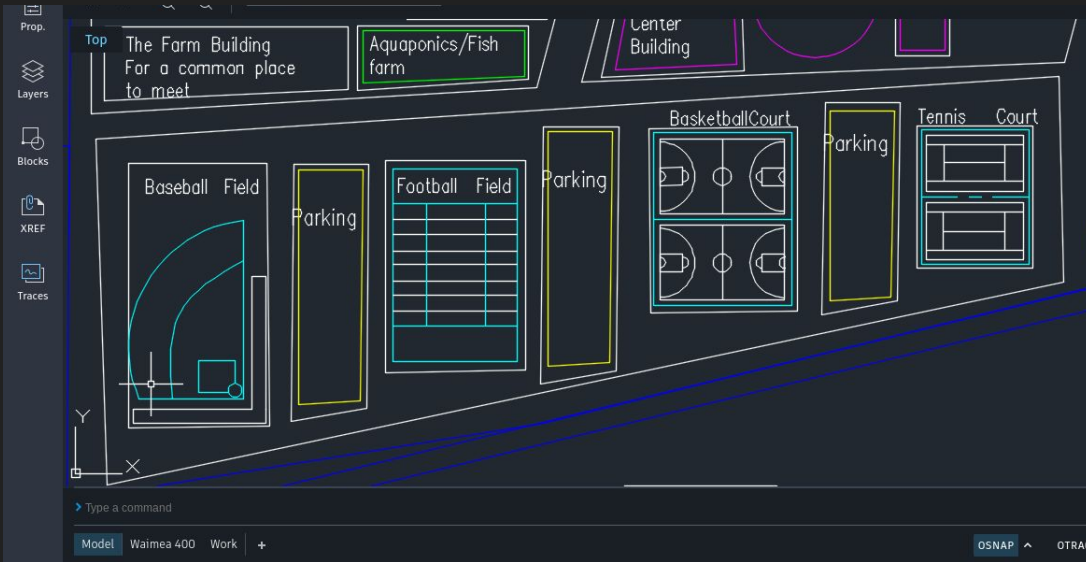

The sports center has a baseball field, a football field, a basketball court, and a tennis court. And because these would take up a lot of room I made a parking space for each section. A downfall to placing the sports center on the bottom of the site is it's in the flood zone.